

# Property Information

For Lease // 3920 North Lovington Hwy  
Hobbs, New Mexico



Offering Summary	
Lease Rate:	\$17.00 SF/yr (NNN)
Building Size:	16,389 SF
Available SF:	5,000 SF
Traffic Count:	±26,000

## Property Overview

Shadow-anchored by Walmart, this property is located on one of the main highways in Hobbs. With up to 5,000 SF of end cap space on one end, this property provides options to tenants with flexible space sizes. This shopping center sees an average of 26,000 cars per day along the Lovington Highway and provides excellent co-tenancy with businesses including OneMain Financial, Hollywood Nail Spa, KidsKare, and Pizza Hut. Other tenants in the vicinity are Holiday Inn, McDonalds, Chili's, Starbucks, and The Plaza Mall.

## Property Highlights

- Shadow Anchored by Walmart
- Great visibility and access
- Excellent co-tendency
- Strong traffic counts

**CMSProperties**

806.794.1492

6306 Iola Ave, #200, Lubbock, TX 79424

[bproctor@cmspropertiesinc.com](mailto:bproctor@cmspropertiesinc.com)

806.794.1492

**CMSProperties**

32412026040



# Retailer Map

For Lease // 3920 North Lovington Hwy

Hobbs, New Mexico



Google

Map data ©2020 Imagery ©2020, CNES / Airbus, Maxar Technologies, NMRGIS, USDA Farm Service Agency

**CMSProperties**

806.794.1492

6306 Iola Ave, #200, Lubbock, TX 79424

[bproctor@cmspropertiesinc.com](mailto:bproctor@cmspropertiesinc.com)

806.794.1492

**CMSProperties**

# SITE PLAN

For Lease // 3920 North Lovington Hwy  
Hobbs, New Mexico

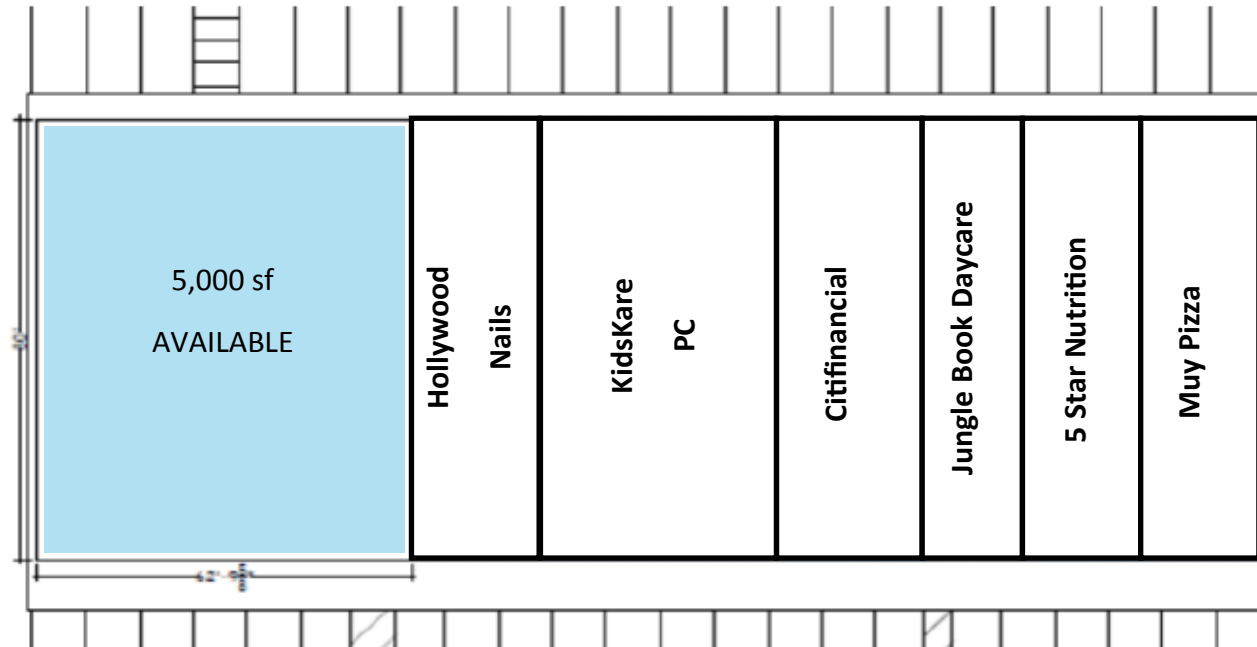

## Available Spaces

Suite	Tenant	Size	Type	Rate	Term	Description
Suite 600	Available	5,000 SF	NNN	\$17.00 SF/yr	Negotiable	Finished out:: former home appliance store

**CMSProperties**

806.794.1492

6306 lola Ave, #200, Lubbock, TX 79424

[bproctor@cmspropertiesinc.com](mailto:bproctor@cmspropertiesinc.com)

806.794.1492

**CMSProperties**